

FAX TO: 250- 789-3089

REGISTERED MAIL

July 29, 2002

Fiberco Pulp Inc.
PO Box 330
Taylor BC V0C 2K0

Attention: Mike Wilchewski, Environmental Coordinator

Dear Mike,

Re: Permit Amendment for PA-07779 – Addition of Baghouse and Name Change

Further to and as per your request dated July 5, 2002, and in accordance with Section 13 of the *Waste Management Act*, Permit PA-07779 (dated September 28, 1988), is hereby amended so the Permit Holder for this permit is now:

Slocan Forest Products Ltd.
Doing Business under the name and style of Taylor Pulp Division
(Producer of Fibreco Pulp)
PO Box 330
Taylor BC V0C 2K0

The following authorized works and conditions have also been added to permit PA-07779 with the addition of Section 1.13 to permit PA-07779.

Section 1.13 Crystal Sulfite Baghouse

1.13.1 The maximum authorized rate of discharge is 6.1 m³/s. The authorized discharge period is an average of 2.0 hours/day, 365 days/year.

1.13.2 The characteristics of the discharge shall not exceed:

Particulate (as sodium sulfite dust) 25 mg/m³

1.13.3 The authorized works are a baghouse, silo and related appurtenances.

Section 7 Loading and Unloading of Material

The Permittee shall take all necessary steps to prevent sodium sulfite dust from entering the atmosphere when loading and unloading the silo.

All other terms and conditions of the subject Permit PA-07779 remain in full force and effect. This letter does not constitute approval by any other agency with jurisdiction over this matter.

Any permit amendments may be appealed to the Environmental Appeal Board. Notice of the appeal must be:

- (1) in writing,
- (2) include the grounds for appeal,

- (3) directed by registered mail or personally delivered to the Chair, Environmental Appeal Board, 4th Floor 836 Yates Street, Victoria, B.C., V8V 1X5,
- (4) delivered within 30 days from the date notice of the decision is given, and
- (5) accompanied by a fee of \$25, payable to the Minister of Finance.

Administration of this Permit will be carried out by staff from our Regional Office located at 3rd Floor, 1011 Fourth Avenue, Prince George, British Columbia, V2L 3H9 (fax: 250-565-6629). As well, hard copies of plans, data and reports pertinent to the Approval are to be submitted to the Regional Waste Manager at this address, with copies of all data and reports to be submitted to the Ministry's sub-regional office at 400 - 10003 - 110th Avenue, Fort St. John, British Columbia, V1J 6M7 (250-787-3392).

Please attach this letter to the original permit.

Yours truly,



Del Reinheimer, P.Eng.
Assistant Regional Waste Manager
Omineca-Peace Region

:msb / cc. Reg Marquardt, Fort St. John.

SITE PLAN A

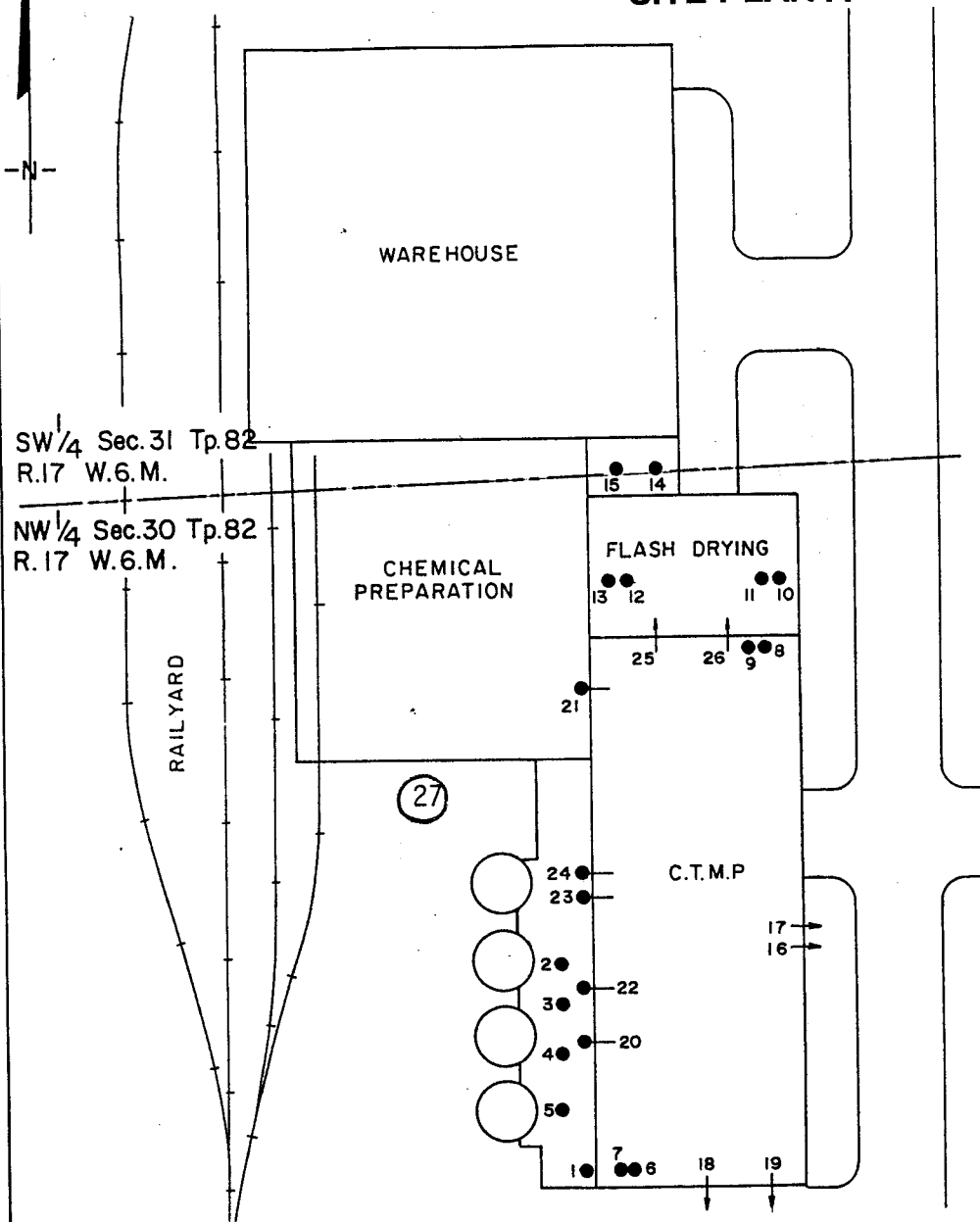

1. Utility Boiler Exhaust
2. Make-up Air Unit #1
3. Make-up Air Unit #2
4. Make-up Air Unit #3
5. Make-up Air Unit #4
6. Make-up Air Unit #5
7. Make-up Air Unit #6
8. Make-up Air Unit #7
9. Make-up Air Unit #8
10. Flash Dryer Cyclone #1
11. Flash Dryer Cyclone #2
12. Flash Dryer Cyclone #3
13. Flash Dryer Cyclone #4
14. Pulp Cooler Cyclone #1
15. Pulp Cooler Cyclone #2
16. Bleach Tower Exhaust
17. Bleach Tower Exhaust
18. Side Hill Screen
19. Chip Bin Vent
20. Reaction/Steaming Bins
21. Rejects Thickener
22. Condenser Outlet
23. Deckers Exhaust #1
24. Deckers Exhaust #2
25. Double Wire Press #1
26. Double Wire Press #2
27. Crystal Sulfitte Baghouse

Location Map

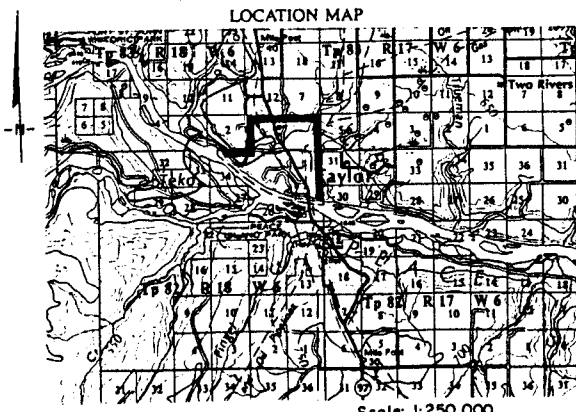

Scale: Not to Scale

Permit: PA-07779

Date:

July 29/02

Del Reinheimer

Del Reinheimer, P.Eng.
Assistant Regional Waste Manager
Omineca-Peace Region

September 28, 1988

REGISTERED MAIL

Fiberco Pulp Inc.
P.O.Box 330
Taylor, British Columbia
V0C 2K0

Attention: Mr. S. Marr, Technical Manager

Dear Sir:

Enclosed is a copy of Permit No. PA-7779 issued under the provisions of the Waste Management Act. Your attention is respectfully directed to the terms and conditions outlined in the Permit.

The administration of this Permit will be carried out by staff from our Regional Office located at 1011 Fourth Avenue, Prince George, British Columbia, (telephone 565-6448). Plans, data and reports pertinent to the Permit are to be submitted to the Regional Waste Manager at this address.

Yours truly,

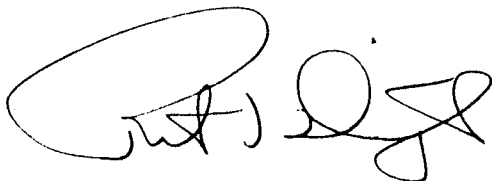
A handwritten signature in black ink, appearing to read 'R.J. Driedger', with a large, stylized initial 'R'.

R.J. Driedger, P.Eng.
Regional Waste Manager

encl.

c.c.: H.A. Simons Ltd., Consulting Engineers, 425 Carrall
Street, Vancouver B.C. V6B 2J6
Attention: Mr. Vernon McAllen



MINISTRY OF ENVIRONMENT

PERMIT

Under the Provisions of the Waste Management Act

Fiberco Pulp Inc.

P.O. Box 330

Taylor, British Columbia

VOC 2K0

is authorized to discharge contaminants from a CTMP pulp mill located at Taylor, British Columbia, to the air.

An annual fee will be determined on the basis of the SIC code 2711 and the related production capacity as defined in the Regulations.

1. Specific Authorized Discharges and Related Requirements

1.1 Four flash dryers.

1.1.1 The maximum authorized rate of discharge from each dryer is $17.9 \text{ m}^3/\text{s}$, 24 hours/day, continuously.

1.1.2 The characteristics of the contaminants are the products of combustion of sweet natural gas, particulate matter to a maximum concentration of $115 \text{ mg}/\text{m}^3$, water vapour, and trace amounts of NaOH, Na_2SO_3 , Na_2SiO_3 , and DTPA.

1.1.3 The works authorized are four flash dryer cyclones and related appurtenances.

A handwritten signature in black ink, appearing to read 'R.J. Driedger', written over a horizontal line.

**R.J. Driedger, P.Eng.
Regional Waste Manager**

1.2 A gas fired utility boiler.

1.2.1 The maximum authorized rate of discharge is $1.72 \text{ m}^3/\text{s}$, 24 hours/day, continuously.

1.2.2 The characteristics of the contaminants are the products of combustion of sweet natural gas.

1.2.3 The works authorized are a stack and related appurtenances.

1.3 Two pulp cooler cyclones.

1.3.1 The maximum authorized rate of discharge from each cyclone is $23.6 \text{ m}^3/\text{s}$, 24 hours/day, continuously.

1.3.2 The characteristics of the contaminants are particulate matter to a maximum concentration of $115 \text{ mg}/\text{m}^3$, water vapour, and trace amounts of NaOH, Na_2SO_3 , Na_2SiO_3 , and DTPA.

1.3.3 The works authorized are two pulp cooler cyclones and related appurtenances.

1.4 A chip bin vent.

1.4.1 The maximum authorized rate of discharge is $1.87 \text{ m}^3/\text{s}$, 24 hours/day, continuously.

1.4.2 The characteristics of the contaminants are particulate matter to a maximum concentration of $115 \text{ mg}/\text{m}^3$.

1.4.3 The works authorized are a chip bin vent and related appurtenances.

1.5 Two bleach tower exhausts.

1.5.1 The maximum authorized rate of discharge from each exhaust is $2.16 \text{ m}^3/\text{s}$, 24 hours/day, continuously.

1.5.2 The characteristics of the contaminants are particulate matter to a maximum concentration of $115 \text{ mg}/\text{m}^3$, water vapour, and trace amounts of NaOH, Na_2SO_3 , Na_2SiO_3 , DTPA and H_2O_2 .

1.5.3 The works authorized are two bleach tower exhausts and related appurtenances.

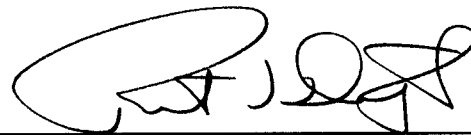

R.J. Driedger, P.Eng.
Regional Waste Manager

1.6 Two double wire press exhausts.

1.6.1 The maximum authorized rate of discharge from each exhaust is $2.10 \text{ m}^3/\text{s}$, 24 hours/day, continuously.

1.6.2 The characteristics of the contaminants are water vapour, and trace amounts of NaOH, Na_2SO_3 , Na_2SiO_3 , DTPA and wood organics.

1.6.3 The works authorized are two double wire press exhausts and related appurtenances.

1.7 Two decker exhausts.

1.7.1 The maximum authorized rate of discharge from each exhaust is $1.45 \text{ m}^3/\text{s}$, 24 hours/day, continuously.

1.7.2 The characteristics of the contaminants are water vapour, and trace amounts of NaOH, Na_2SO_3 , Na_2SiO_3 , and DTPA.

1.7.3 The works authorized are two decker exhausts and related appurtenances.

1.8 A condenser outlet.

1.8.1 The maximum authorized rate of discharge is $1.52 \text{ m}^3/\text{s}$, 24 hours/day, continuously.

1.8.2 The characteristics of the contaminants are water vapour.

1.8.3 The works authorized are a condenser outlet exhaust and related appurtenances.

1.9 A reaction/steaming bin.

1.9.1 The maximum authorized rate of discharge is $1.17 \text{ m}^3/\text{s}$, 24 hours/day, continuously.

1.9.2 The characteristics of the contaminants are water vapour and trace amounts of Na_2SO_3 and wood organics.

1.9.3 The works authorized are a reaction/steaming bin vent and related appurtenances.

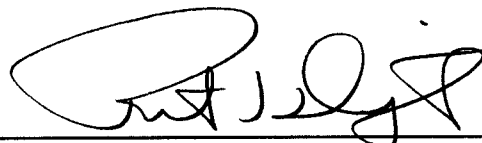

R.J. Driedger, P.Eng.
Regional Waste Manager

1.10 A side hill screen.

1.10.1 The maximum authorized rate of discharge is $2.36 \text{ m}^3/\text{s}$, 24 hours/day, continuously.

1.10.2 The characteristics of the contaminants are water vapour and trace amounts of NaOH, Na_2SO_3 , Na_2SiO_3 , DTPA and wood organics.

1.10.3 The works authorized are a side hill screen vent and related appurtenances.

1.11 Eight make-up air vents.

1.11.1 The maximum authorized rate of discharge from each vent is $0.29 \text{ m}^3/\text{s}$, 24 hours/day, continuously.

1.11.2 The characteristics of the contaminants are the products of combustion of sweet natural gas.

1.11.3 The works authorized are eight vents and related appurtenances.

1.12 A rejects thickener.

1.12.1 The maximum authorized rate of discharge is $1.44 \text{ m}^3/\text{s}$, 24 hours/day, continuously.

1.12.2 The characteristics of the contaminants are water vapour and trace amounts of NaOH and Na_2SO_3 .

1.12.3 The works authorized are a rejects thickener vent and related appurtenances.

2. General Requirements that Apply to All of the Authorized Discharges

All air and gaseous volumes are at standard conditions which are:
std.temp. = 293.15^0K ; std. pressure = 101.325 KPa;
water vapour = zero.

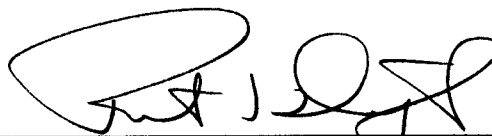

R.J. Driedger, P.Eng.
Regional Waste Manager

3. Location of the Facilities

The location of the authorized discharges and related facilities are the SW¹/₄ of Section 31 and the NW¹/₄ of Section 30, Township 82, Range 17, W.6.M.

4. Maintenance of Works and Emergency Procedures

The Permittee shall inspect the pollution control works regularly and maintain them in good working order. In the event of an emergency or condition beyond the control of the Permittee which prevents continuing operation of the approved method of pollution control, the Permittee shall immediately notify the Regional Waste Manager and take appropriate remedial action.

4. Bypasses

The discharge of contaminants which has bypassed the designated treatment works is prohibited unless the consent of the Regional Waste Manager is obtained and confirmed in writing.

5. Process Modifications

The Permittee shall notify the Regional Waste Manager prior to implementing changes to any process that may affect the quality and/or quantity of the discharge.

6. Monitoring

Visual monitoring of the discharges authorized by Sections 1.1, 1.3, 1.4, and 1.5 above will be carried out by Waste Management staff as part of an ambient monitoring program for the entire mill operation. Based on these monitoring results, the Permittee may be required to undertake source monitoring.

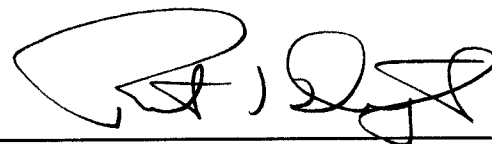

R.J. Driedger, P.Eng.
Regional Waste Manager

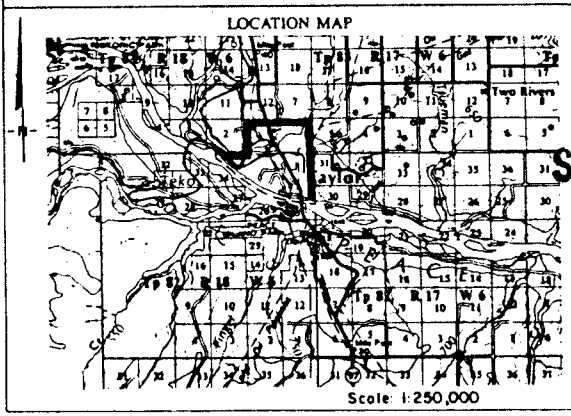
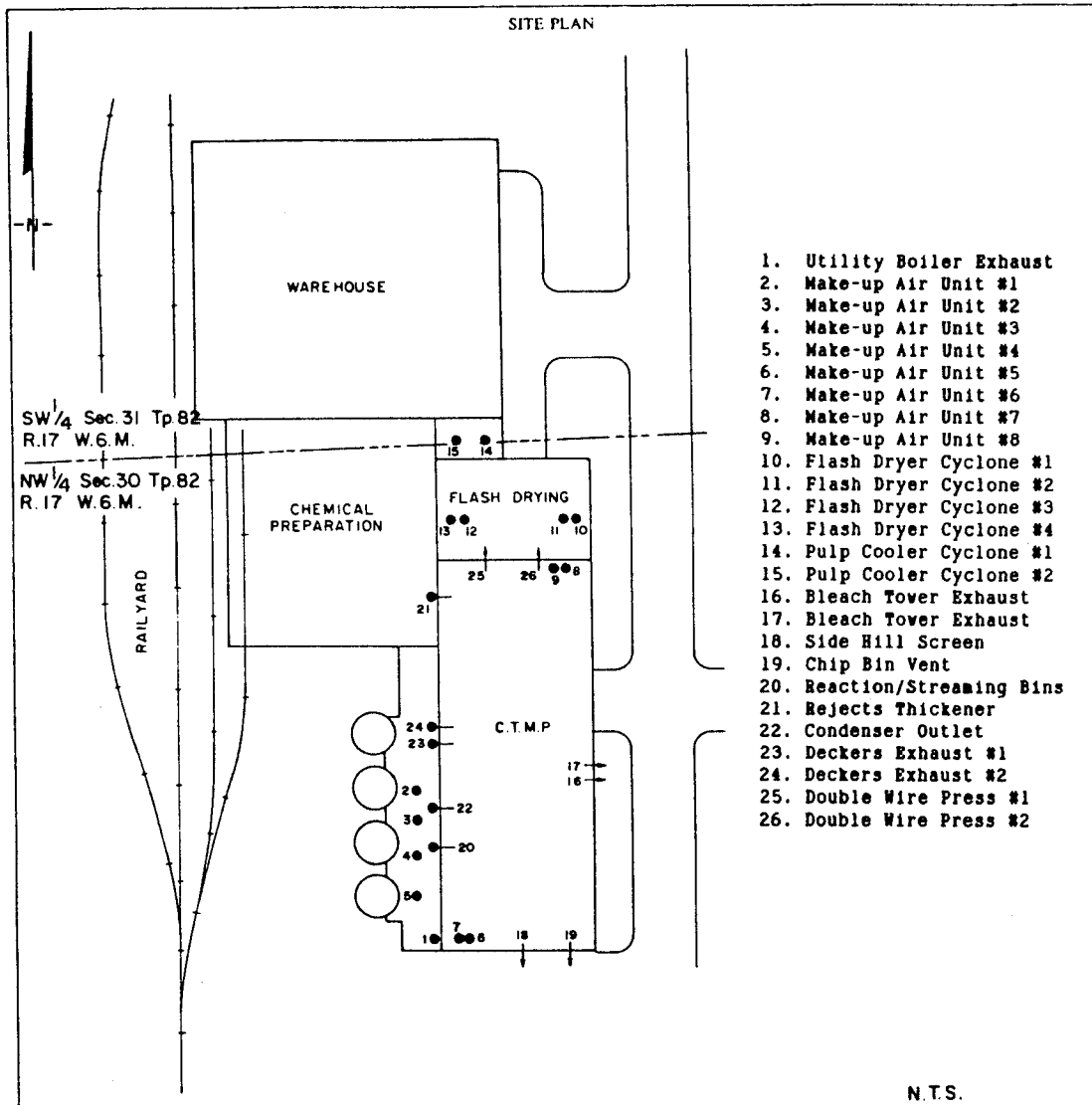

Fibreco Pulp Inc.
(Name of applicant(s))

(Date) (Signature of applicant(s) or agent)

SEP 28 1988 (FOR OFFICE USE ONLY)

Date Issued _____

Date Amended _____

R. J. Driedger, P. Eng.
Regional Waste Manager

Appendix A-1 to Permit No. **PA-7779**

Approval No. _____